

FENIX

+

FENIX
PLUS

USER MANUAL

PRODUCT CODES

WC09084 | WC09085

Careco UK Limited , Hubert Road, Brentwood, Essex, CM14 4JE

CONTENTS _____

1. PREFACE	1
2. SAFETY NOTICES	2
3. PARTS	3
4. ASSEMBLY & DISASSEMBLY	4
5. COMFORT ADJUSTMENT	6
6. OPERATION	8
7. CHARGER	9
8. INSPECTION & MAINTENANCE	10
9. TROUBLE SHOOTING	11
10. SPECIFICATION	12
11. WARRANTY	13

1. PREFACE

Please read this user manual before using your Fenix Powerchair. Improper use of the power wheelchair could result in harm, injury or traffic accidents.

This user manual includes operation instructions for every aspect of the power wheelchair, assembly instructions, as well as a troubleshooting guide.

The symbol used in this manual is explained below. Read carefully, especially the parts marked with this symbol:



Warning

Improper usage could result in serious injury or death

This manual includes the repair and maintenance record chart and warranty. Please keep in a safe place or on the wheelchair.

If someone else uses the power wheelchair, please be sure to give the instruction manual to him or her.

As designs change, some illustrations and pictures in the manual may not correspond to the power wheelchair that you purchased. We reserve the right to make the design modifications.

The manufacturer disclaims all responsibilities for any personal injury or property damage which may occur as a result of improper or unsafe use of its products.

2. SAFETY NOTICES

Become familiar with the operation of your wheelchair before first use and keep these safety notices in mind.

The same traffic rules for pedestrians apply to the use of the wheelchair.

1. Always fully charge your power wheelchair before operating.
2. Always make sure the power is off when getting in and out of the power wheelchair.
3. Always make sure the freewheel levers are engaged (parallel to the wheels) before getting in or out of the power wheelchair.
4. To prolong the life of the battery, it is suggested you charge the battery after every trip. If you do not drive it for long periods of time, charge it as least once per month.
5. If the battery gauge goes to RED, charge the battery as soon as possible. If the battery is fully discharged, it could be damaged, and/or its life could be shortened.
6. As the battery ages and deteriorates, the batter power will decrease faster.
7. In cold weather, the battery capacity will be less.
8. When you are charging the battery, please make sure that the input voltage (100V/240V) switch on your charger matches your power source.
9. Avoid unnecessarily moving the power wheelchair.
10. Please fasten the seat belt whilst driving and check the position of the anti-tip wheel.
11. The product functions best at temperature between 0°C – 50°C (32°F – 122°F).
12. Disassembling of controller, motor or charger by the end user is prohibited; CareCo will not take any responsibility in these situations.
13. Prevent the controller, charger and battery from getting wet; this can cause a malfunction.
14. To ensure the users familiarity with the power wheelchairs operation, the new driver should practice driving in a spacious area, travelling forward, backward, left, right, using the brakes and going both up and down slopes.
15. Please turn off the power wheelchair when it is not in use and before charging the battery.
16. The following areas and conditions can be dangerous and should be avoided; darkness, dim lighting, steep slopes, rain, snow, slippery areas, etc.
17. Please do not drive your power wheelchair at night without adequate lighting.
18. Please do not lower the footplate to less than 2" (50mm) above the ground, because accidents may occur due to insufficient ground clearance.
19. Keep your feet on the footplate at all times during operation and do not stand on the footplate. If your feet are in an improper position, you can be seriously injured.
20. If there is no power, recheck all connections and recharge if necessary.
21. Please check the screws under the joystick periodically and make sure they are not loose, tighten them in required.
22. The power wheelchair will not operate whilst charging the battery.

3. PARTS

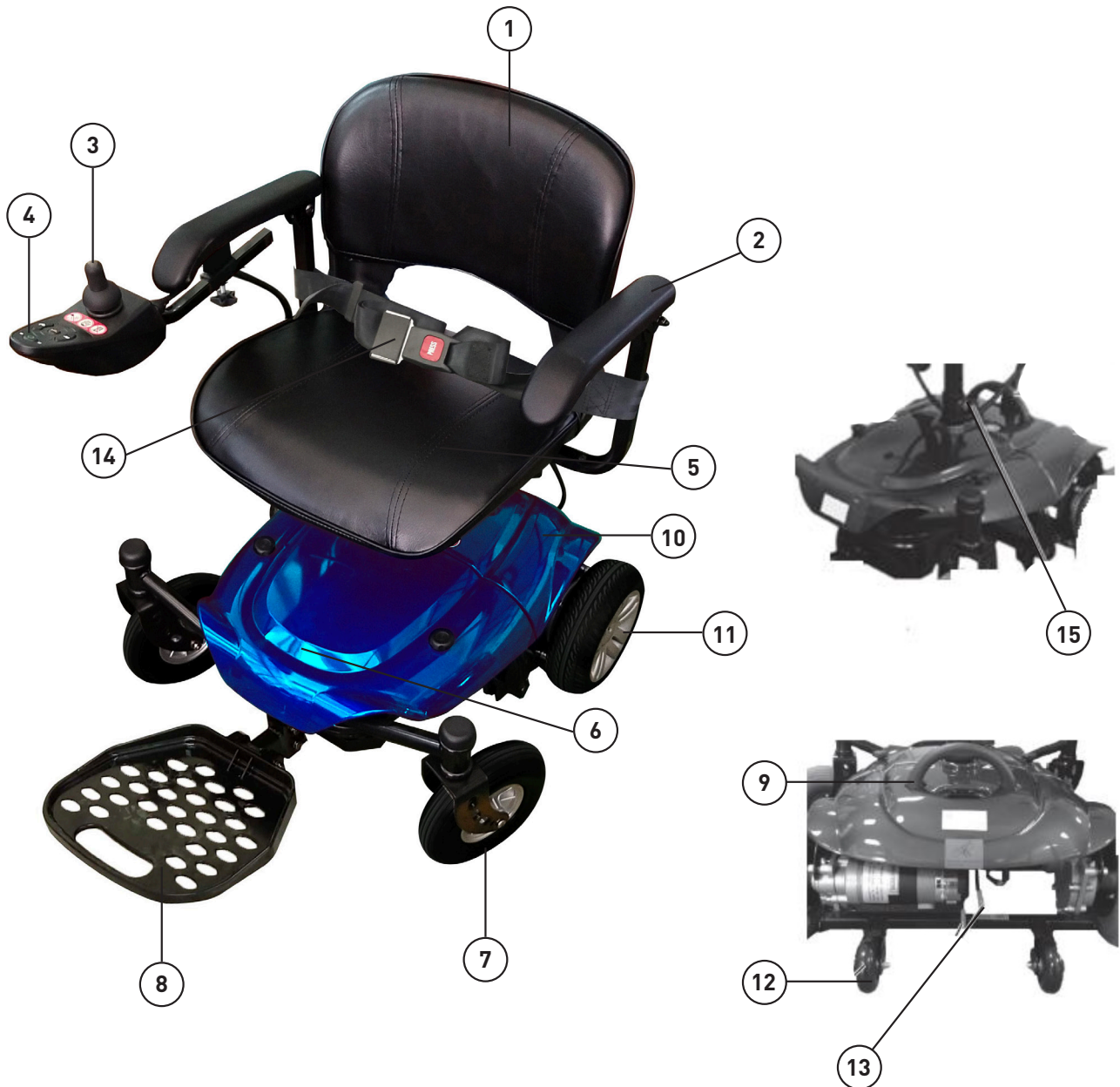

- 1. Backrest
- 2. Armrest
- 3. Joystick
- 4. Controller
- 5. Seat
- 6. Front Cover

- 7. Front Caster
- 8. Footplate
- 9. Carry Handle
- 10. Rear Cover
- 11. Rear Drive Wheel
- 12. Anti-tip Wheels

- 13. Manual Freewheel
Lever
- 14. Seat Belt
- 15. Frame Lock/Release
Lever

4. ASSEMBLY & DISASSEMBLY

1. Connect the front and rear frame by matching the semicircular pegs with the frame. When correctly positioned a 'click' will sound from the frame lock/release lever.

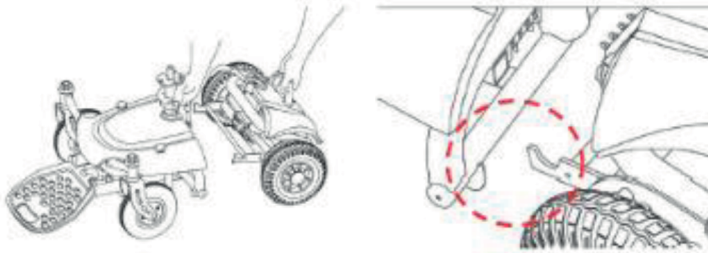

2. Remove the front cover by unscrewing the 2 bolts. Place battery pack on the front frame. Connect battery pack connectors with the main cable and then fasten battery pack with the safety straps.

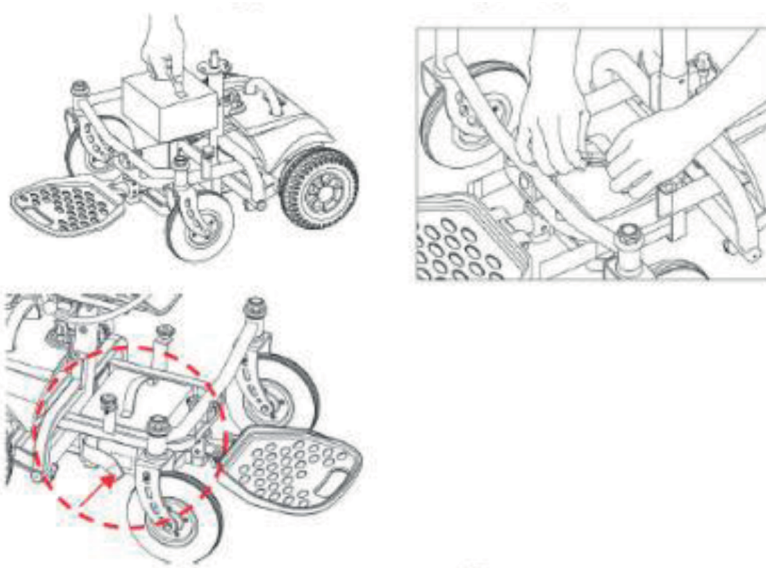

4. ASSEMBLY & DISASSEMBLY

3. Re-place the front cover on the frame. Fasten the 2 bolts on the cover.

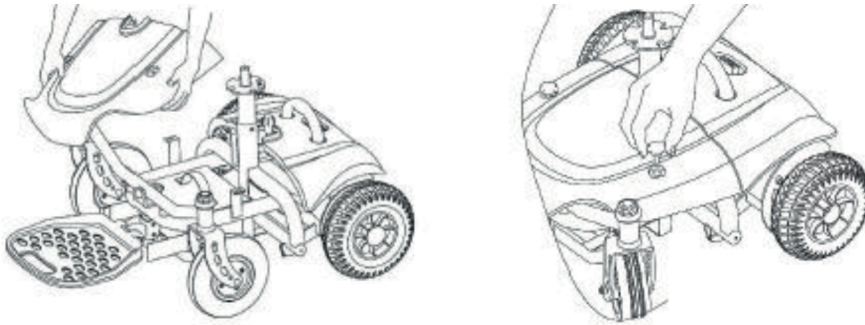

4. Insert the seat into the seat post and secure using the nut and bolt. Then place the seat down on the wheelchair's seat post. Now, attach the seat belt through the armrest of the chair and secure.

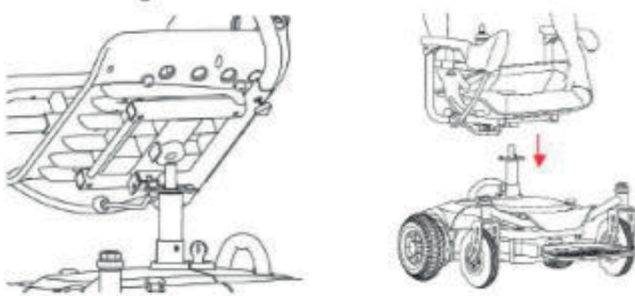

5. Connect the controller cable on the rear cover. Turn on the controller to make sure the power is on.

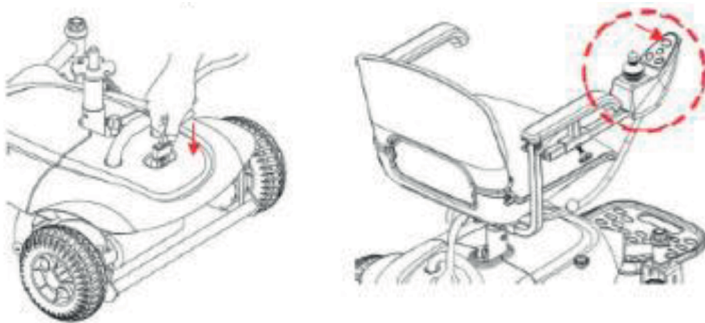

To disassemble follow the instructions above in reverse order.

5. COMFORT ADJUSTMENT

1. The seat can be rotated left or right to help the user get on and off more conveniently, by lifting up the handle on the right side of the seat.

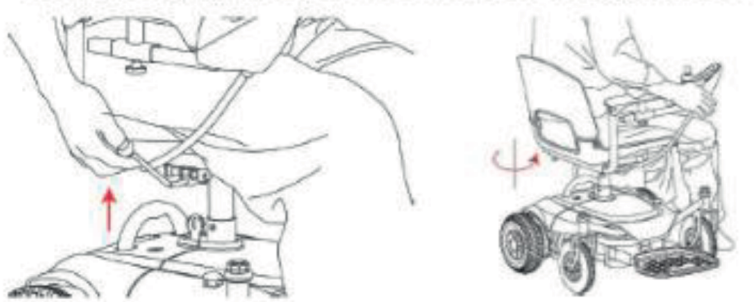

2. The position of the controller can be adjusted forward or backward by loosening the bolt located under the armrest. The width of the armrests is also adjustable, by loosening the bolt located under the seat.

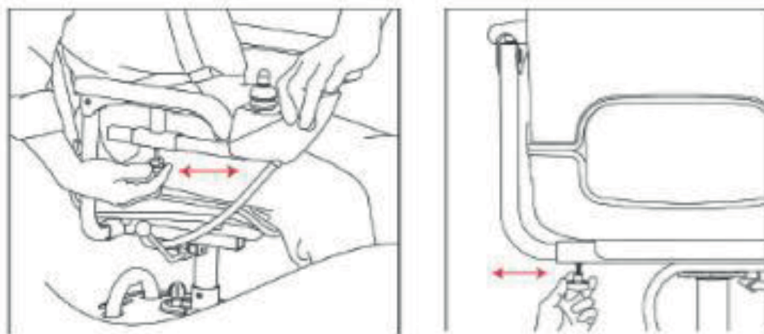

3. The height of the footplate can be adjusted to 2 positions.

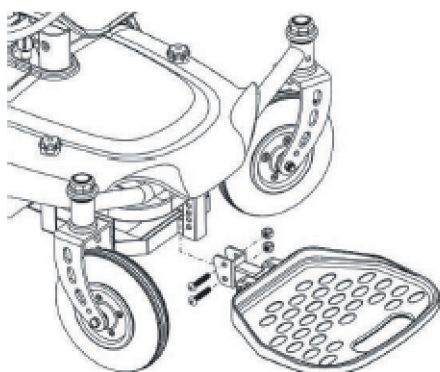

5. COMFORT ADJUSTMENT

4. The height of the seat can be adjusted to 4 positions.



5. OPERATION

GENERAL INFORMATION

1. Make sure that the motor levers are in engaged mode (parallel to the wheels.)
2. Once seated on the power wheelchair, turn on the power (press the power button). The battery gauge will turn on.
3. We suggest new users operate the power wheelchair in low speed until fully conversant with all its functions and features.
4. Start to steer, moving the joystick to drive forward, backward, left or right. If you want to stop the power wheelchair, release the joystick – it will automatically return to the centre position and stop the power wheelchair.
5. The power wheelchair's speed is automatically reduced by half when the power wheelchair is turning.
6. When driving the power wheelchair on a slope, push the joystick forward to keep the power wheelchair continuously climbing until you reach the top of the slope. While the power wheelchair is climbing a steep slope, position your body forward to prevent the front wheels from lifting.
7. When driving the power wheelchair down a slope, drive slowly and prepare for an emergency stop if you feel it is difficult to control the power wheelchair. If the speed increases, release the joystick to slow down or to stop, then start again at a slower speed.

6. OPERATION

CONTROLLER



BATTERY INDICATOR

When the power wheelchair is turned on, the battery gauge will light up as indicated below:

Green lights: the battery has full capacity.

Yellow lights: do not drive power wheelchair for a long trip.

Red lights: the power wheelchair should be charged as soon as possible.

7. CHARGER

SPECIFICATION

Input Current	2A dc+5%
Output Voltage	24.0Vdc+2%
Input Voltage	95-250Vac
Output Detection	1. Short Circuit Detection 2. Output Voltage /Current Limit 3. Reverse Power Protected
Operating temperature	0°~40°C
Weight	365g approx.

INSTRUCTIONS

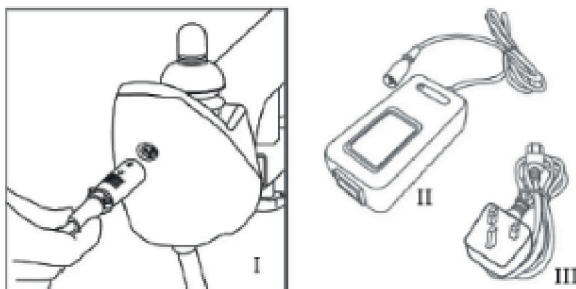

1. Connect the charger to the controller (figure I). Then connect the power lead (figure II) into the battery charger. Finally, connect the 3 pin plug into the mains (figure III).
2. Switch the power on to charge the battery.
3. When the LED turns green the battery is fully charged.
4. Unplug from the mains and controller, then store safely and out of a reach of children.



Warning

Ensure charging using lead acid batteries only.

7. CHARGER

Warning

1. Ensure the output – DC voltage corresponds to the battery type and voltage. Otherwise it may cause damage to the charger/battery.
 2. Switch off the charger before connecting the charger and the battery.
 3. Do not expose the charger to rain, water or flammable materials.
 4. The warranty is given for use within normal operating conditions; it does not cover accidental damage, or problems caused as a result of a user neglect or misuse.
 5. Please keep the charger at least 2 inches away from other objects when charging.
 6. Do not use it on wet and dirty surfaces.
 7. Do not place the charger on the battery.
 8. Always charge the battery in a well ventilated area.
-

8. INSPECTION & MAINTENANCE

BATTERY

Please charge the battery after long distances to prolong battery life. If you do not drive the power wheelchair for a long period of time, then charge at least every month. Replace with a maintenance/water-free battery to avoid any problems, available from your dealer.

MOTOR

The carbon brush connector and brakes should be carried out on a level floor with at least three feet of clearance space around the power wheelchair.

ELECTRICAL BRAKES

Testing of the electrical brakes should be carried out on a level floor with at least three feet of clearance space around the power wheelchair.

Power on the controller, and push the joystick forward slowly until you hear the electrical brake working. The power wheelchair may start to move. Immediately release the joystick, you must be able to hear each electrical brake within a few seconds. Repeat the test three times, pushing the joystick backward, left and right respectively.

SOLID TYRES







Check front/rear regularly and replace them when worn out.

9. TROUBLE SHOOTING

If a system fault occurs, the battery gauge LED's will start to flash.

Count the number of LED's and refer to the table below.

If the problem persists after you made the checks described above, contact your dealer.

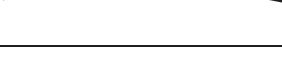
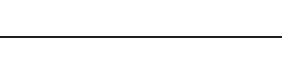
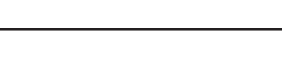
Error code	Possible Cause	Solution
1 	Battery needs recharging or bad connection to the battery	Check the battery cables and connections. Try charging the batteries. Batteries may need replacing.
2 	Left hand motor has a bad connection	Check the connections to the left hand motor.
3 	Left hand motor has a short circuit to be battery connection	Contact your dealer.
4 	The right hand motor has a bad connection.	Check the connections to the right hand motor.
5 	Right hand motor has a short circuit to the battery connection.	Contact our dealer.
6 	The chair is being prevented from driving by an external signal.	Depends on the type of chair, one possibility is the charger is still connected.
7 	Issue with joystick.	Make sure the joystick is in the centre position before switching the controller on.
8 	A controller system fault.	Make sure all connections are secure.
9 	A parking brake has a bad connection.	Check the parking brake and motor connections. Make sure the controller system connections are secure.
10 	Excessive voltage has been applied to the controller system.	Usually caused by poor battery connection. Check the battery connections.

10. SPECIFICATION

MODEL	FENIX	FENIX PLUS
Max Weight Capacity	250lbs/115kg	250lbs/115kg
Speed	4mph	4mph
Estimated Range	15 km	20 km
Maximum Grade / Incline	6"	6"
Turning Radius	23.6"	23.6"
Ground Clearance	40mm	40mm
Overall Length	895 mm	895 mm
Overall Width	695 mm	695 mm
Overall Height	32.8" – 35.8" / 835 – 910mm	32.8" – 35.8" / 835 – 910mm
SEAT DIMENSIONS		
Chair Width	16.75"	16.75"
Chair Length	13.5"	13.5"
Backrest Width	16.5"	16.5"
Backrest Length	13.5"	13.5"
POWER		
Motor	24V x 120W x 2	24V x 120W x 2
Controller	40A	40A
Batteries	Two DC12V X 12AH	Two DC12V X 21AH
Battery Charger	2Amp, Off Board	2Amp, Off Board
Brakes	Electromagnetic	Electromagnetic
Freewheel Mode	Yes	Yes
Solid Tyres	Yes	Yes
Front Casters	7.8" PU	7.8" PU
Rear Drive Wheels	8.5" PU	8.5" PU

11. WARRANTY

Warranty starts from cargo arrival date, two years comprehensive warranty, but battery/wheel/consumables with half year warranty.

Consumables parts include:

- Motor carton brush
- Front/rear shroud
- Battery fabric bag
- Woven band accessories
- Seat belt
- Seat cover

NOTES

NOTES

FENIX

+

FENIX

PIUS

CareCo